

# CVB V-Belt Live Roller Conveyor

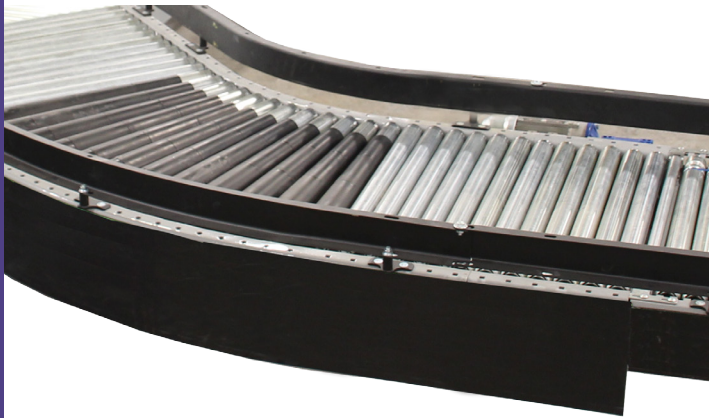

Automation's Model CVB V-Belt driven conveyor incorporate a modular bolt together design enabling numerous job specific assemblies to be configured from a handful of standard modular components. These motor driven or slave driven units are available in a full array of curve, straight and junction configurations to satisfy your specific curve, merge, or divert layout requirements.

Automation's standard curve offering features true taper rollers in the arced section of the curve so cartons negotiate turns smoothly and quietly without changing carton orientation.

Automation's V-Belt Live Roller Conveyor was designed with ease-of-maintenance in mind. In addition to durable galvanized rollers, these economical and easy-to-install units feature specially designed snub driveshafts allowing belts to be replaced without disassembling the conveyor.

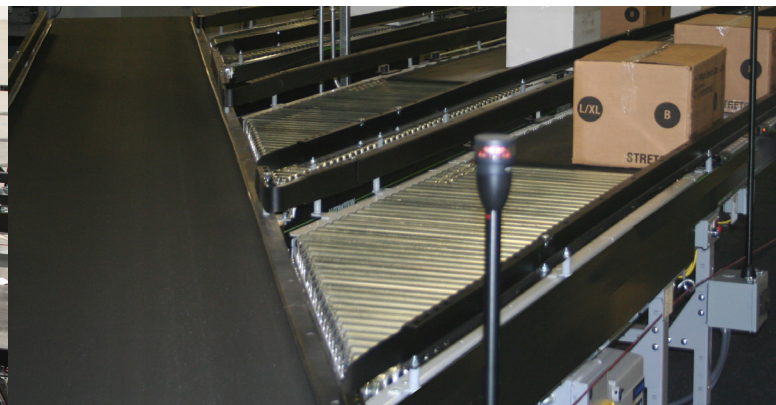

## Mechanical Characteristics

### Bed Section

10" Deep x 12 Gauge CSC frame.

### Galvanized Rollers

**Carrying:** 1-7/8" Diameter, 16 Gauge carrying roller with 7/16" hex axle.

**Tapered Carrying:** 1-7/8" Diameter (small end), tapered carrying roller with 7/16" hex axle.

### Drives

Slave driven module or motor driven module with belt take-up. 3/4 HP to 1-1/2 HP. Speed range is 70-600 FPM.

### Belt

"B" Section V-Belt.

### Axle Isolators

Specially designed conductive plastic insert isolates carrying roller axles from the conveyor frame to reduce noise and prevent wear.

### Finish

Light gray powder coat paint. Black side cover.

**Technical Detail**

**Elevation View**

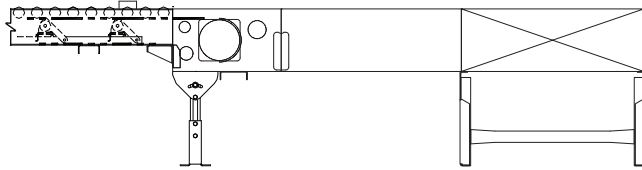

**Plan View**

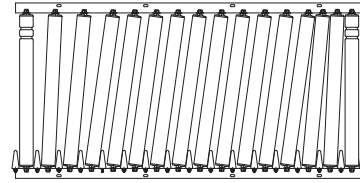

**Section View**

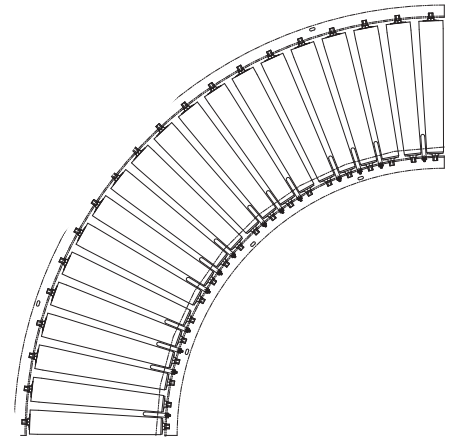
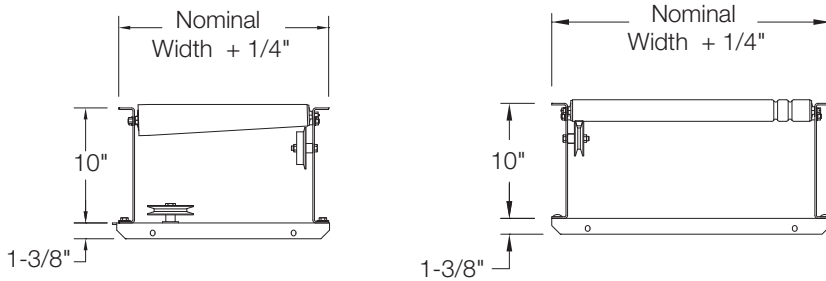

**Specifications**

**Typical Applications**

- Transportation
- Transfer (junctions for merge and divert applications).
- Alignment

**Live Load Capacity**

Up to 100 lbs/ft. depending on width, roller centers, supports, etc.

**Standard Curve Offering**

30°, 45°, 60°, 90°, and 180°

**Tight Radius Curve Offering**

90° and 180°

**Standard Junction Offering**

30° and 45°

**Standard Nominal Widths**

18", 24", 30", 36" and 42"

**Tight Radius Nominal Widths**

18", 24", and 30"  
(Inside Radius 13-1/2")

**Carrying Roller Centers**

2" and 3"

**Standard Features**









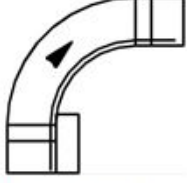
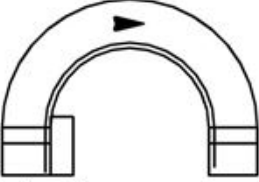

Pulley guards and covers.  
Bolt-on top guard rail 3", 6", and 12" high. Powder coat paint color flat black.  
Guard rail system provides nominal width between guard rails.

**Options**

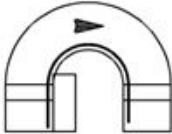
Guard Rails and Supports.  
Slave or Motorized Drive.  
Five standard optional powder coat paint colors. Special colors available.

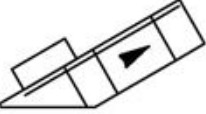
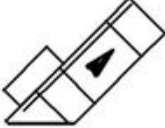
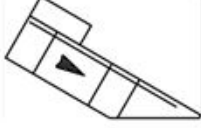
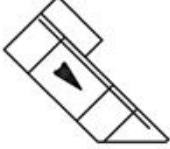
## Technical Details

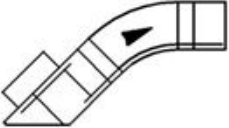
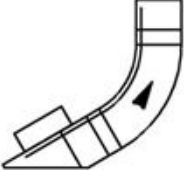
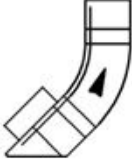
CVB is available in the following configurations:

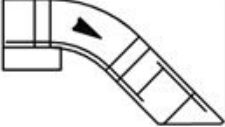
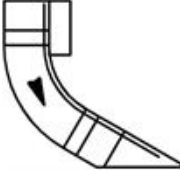
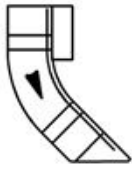
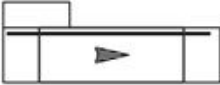
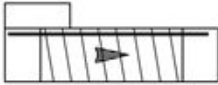
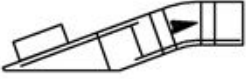
30-deg. curve <sup>α</sup> 	45-deg. curve <sup>α</sup> 	60-deg. curve <sup>α</sup> 	90-deg. curve <sup>α</sup> 
180-deg. curve <sup>α</sup> 	90-deg. tight-radius curve <sup>α</sup> 	180-deg. tight-radius curve <sup>α</sup> 	30-, 45-, 60-, & 90-s-curves <sup>α</sup> 
30-deg. diverge <sup>α</sup> 	45-deg. diverge <sup>α</sup> 	30-deg. merge <sup>α</sup> 	45-deg. merge <sup>α</sup> 
30/30-spur diverge <sup>α</sup> 	45/45-spur diverge <sup>α</sup> 	30/60-diverge <sup>α</sup> 	45/45-diverge <sup>α</sup> 
30/30-spur merge <sup>α</sup> 	45/45-spur merge <sup>α</sup> 	30/60-merge <sup>α</sup> 	45/45-merge <sup>α</sup> 
straight <sup>α</sup> 	skew <sup>α</sup> 	20/20-spur diverge <sup>α</sup> 	20/70-spur diverge <sup>α</sup> 